

*A professional supplier of DC electric Aircon. system for trucks,
construction & agriculture machinery and other specialty vehicle markets*



Outdoor unit



Indoor unit

DC12V/24V Split Mounted Air Conditioner - cools when engine on or off, no fuel consumed

Key Benefits

- * 100% powered by 12V/24 battery, cools when engine on or off
- * DC electric compressor used, strong cooling power, with 8900BTU cooling in accordance with JIS standard
- * Soft started, no flash current, safety and stable
- * Double battery protection, no damage to battery
- * Split mounted, no drills on the cabin roof
- * R-134a pre-filled, safety and environment friendly
- * One year warranty

Description

1. Standalone air conditioning for the NIGHT-TIME and DAY-TIME use working with the engine switched OFF and ON, maintaining the temperature during the day.
2. This unit is used mainly to cool down the driver cabin during the driver's overnight rest periods and during loading and unloading operations.
3. Wide range of applications: Light & heavy duty trucks, construction machinery, agricultural machinery, mobile workshops, and any other equipment with 3-5cbms cooling space.

Product specifications

Model No.	E-2600PRO	E-2600PRO
Rated input voltage	DC24V	DC12V
Working voltage range	DC21.5~32V	DC10.5~15.5V
Rated cooling capacity(*)	2600W/8900BTU	2000W/6850BTU
Rated input power(*)	912W	576W
Rated current consumption(*)	38A	48A
Current draw range	10~45A	/
Airflow	450m3/Hr	500m3/Hr
Working refrigerant	R-134a(610±20g)	R-134a(610±20g)
Compressor Type	24V electric compressor	12V electric compressor
Weight	10kg / 22lb(Interior unit) 25kg / 55lb (Exterior unit)	10kg / 22lb(Interior unit) 25kg / 55lb (Exterior unit)
Dimensions(L*W*H)	682*465*192mm (outdoor unit) 540*362*165mm (Indoor unit)	682*465*192mm (outdoor unit) 540*362*165mm (Indoor unit)

1. (*) In accordance with JIS standard, test conditions: outside temperature 35°C, return temperature 27 °C
2. Being product improvement or updates, parameters will be changed without prior notice
3. The AC is designed for T1 climat type(21°C~43°C).

Drawings of -2600F

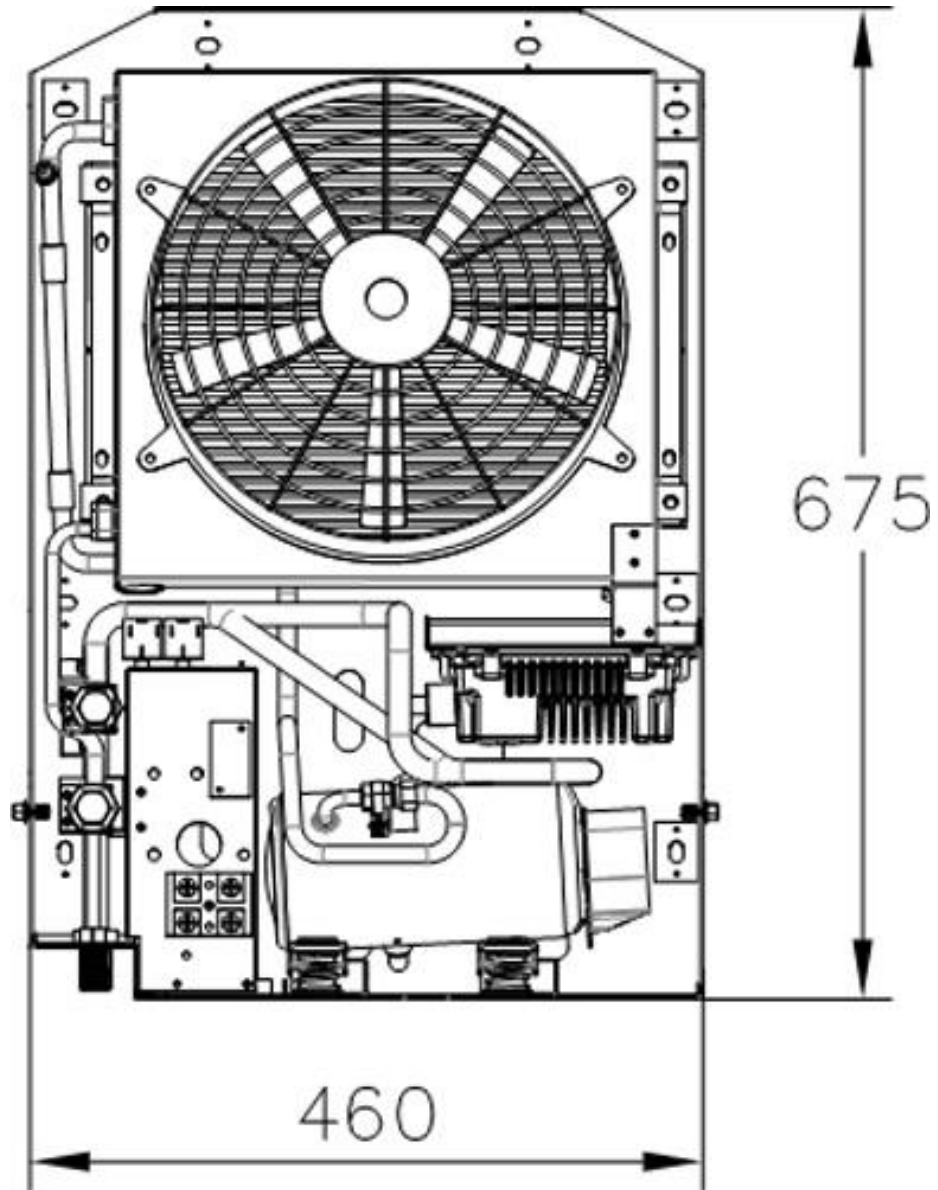

Outdoor unit dimension: 681*465*192(L*W*H)

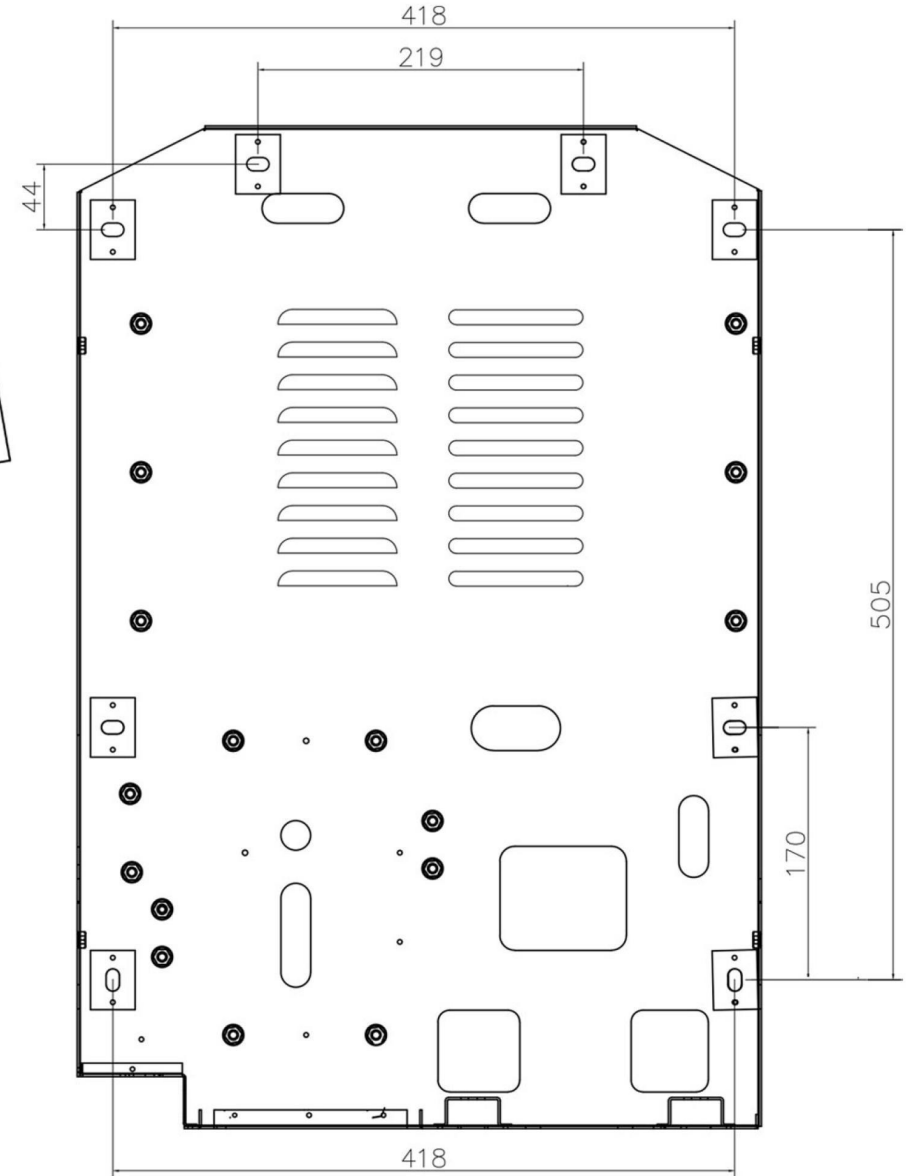
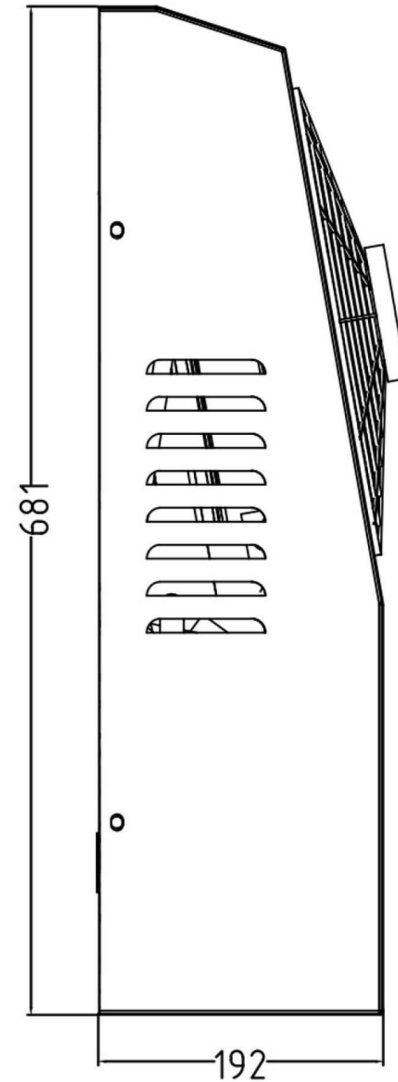

Installation size: 418*505mm

Drawings of -2600F

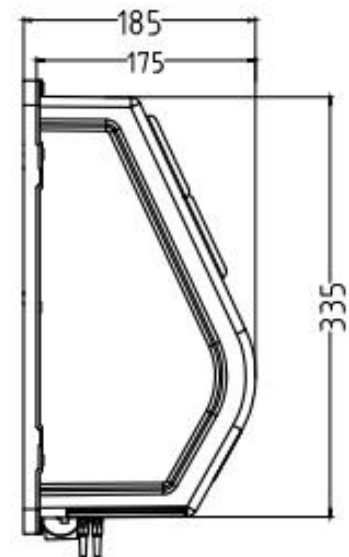
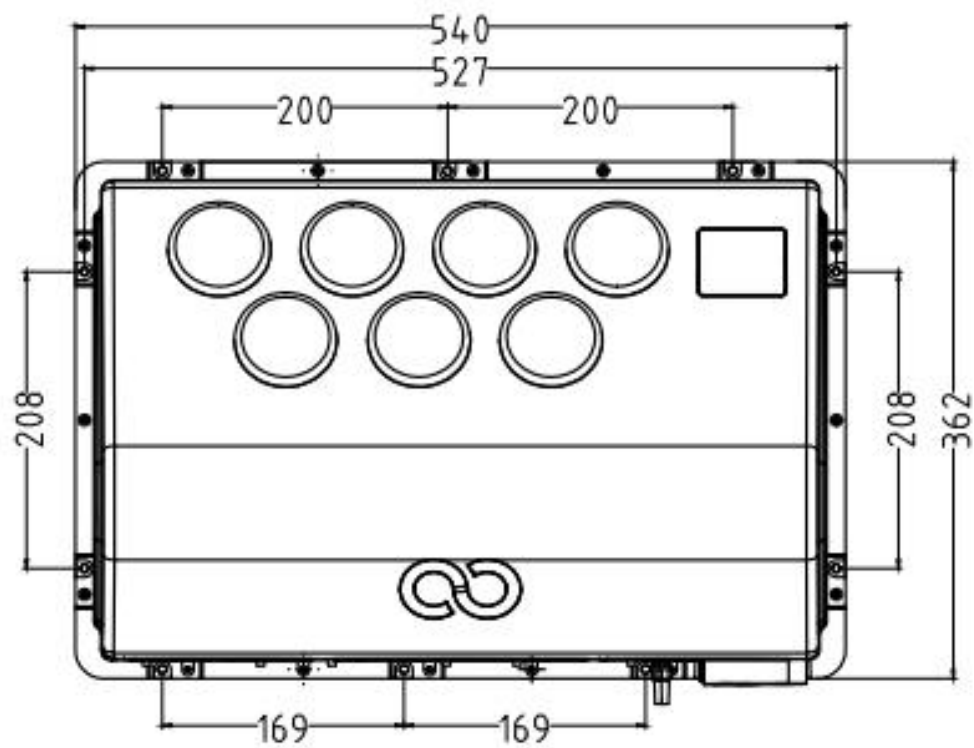
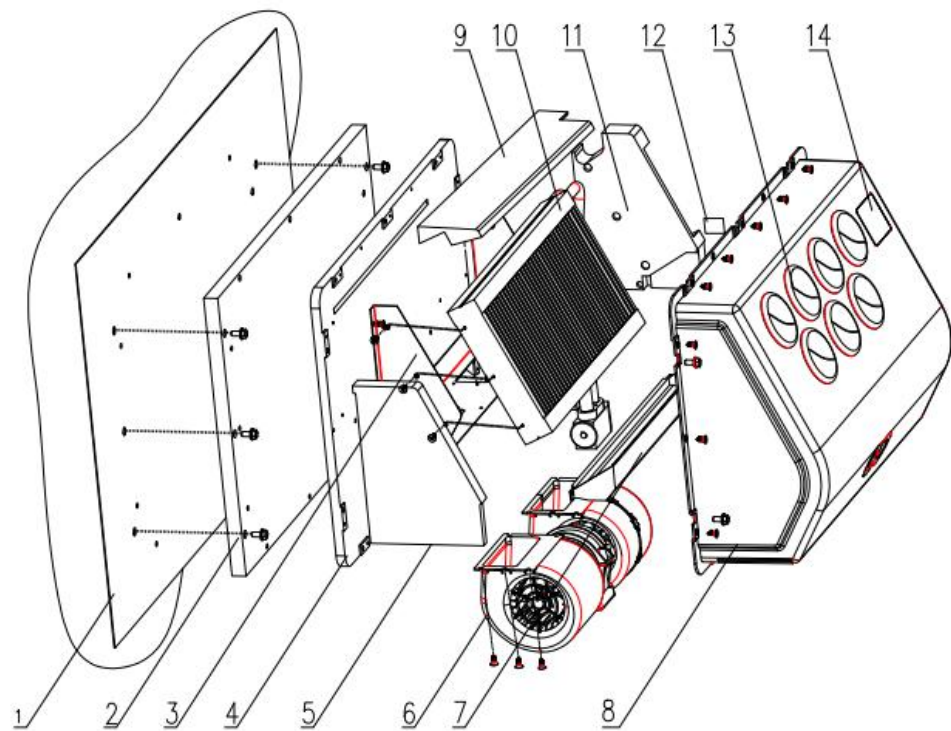

Applications

